

Wide Band / GPS 2 Way Splitter, SMA, L1 - L5

698 - 2700 MHz, 2 Port DC Pass, Current Sharing

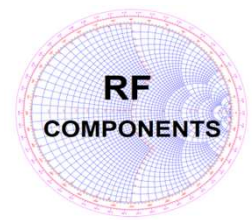

RFCOMPONENTS.COM.AU

PART NUMBER RFC-GPS-2-2CS

ELECTRICAL SPECIFICATIONS:

1.) FREQUENCY RANGE:	698 - 2700 MHz
2.) IMPEDANCE:	50 OHMS
3.) INSERTION LOSS (MAX):	0.5 dB (ABOVE 3.01 dB SPLIT)
4.) AMPLITUDE BALANCE (MAX):	0.2 dB
5.) PHASE BALANCE (MAX):	3 DEGREES
6.) ISOLATION (MIN):	22 dB
7.) INPUT VSWR (MAX):	1.25 : 1
8.) OUTPUT VSWR (MAX):	1.20 : 1
9.) DC VOLTAGE (MAX):	100 VOLTS
10.) DC CURRENT (MAX):	1 A

MECHANICAL SPECIFICATIONS:

1.) CONNECTORS:	SMA FEMALE (JACK), 50 OHM
2.) CONNECTOR BODY:	BRASS, TRI-ALLOY PLATE
3.) CONNECTOR PIN:	BERYLLIUM COPPER, GOLD PLATE
4.) INSULATOR:	PTFE, VIRGIN ELECTRICAL GRADE
5.) HOUSING:	ALUMINUM, CLEAR CHEM CONVERSION FILM, RoHS COMPLIANT (NO HEX CHROM)
6.) SOLDER:	LEAD FREE, RoHS COMPLIANT
7.) OPERATING TEMP:	-65°C TO +85°C
8.) WEIGHT:	136 GRAMS

RF INPUT POWER RATING (POWER DIVIDER SPLITTER):

INTO MATCHED LOAD VSWR's	IN-PHASE	180° OUT-OF-PHASE
1.2 : 1	40 WATTS	40 WATTS
2.0 : 1	40 WATTS	10 WATTS
∞	20 WATTS	1 WATT

RF INPUT POWER RATING (POWER COMBINER):

COHERENT SIGNALS (IN-PHASE)	2 X 20 WATTS
COHERENT SIGNALS (180° OUT-OF-PHASE)	2 X 0.5 WATTS
NON-COHERENT SIGNALS	2 X 1 WATT
OTHER CONDITIONS - CONSULT FACTORY	

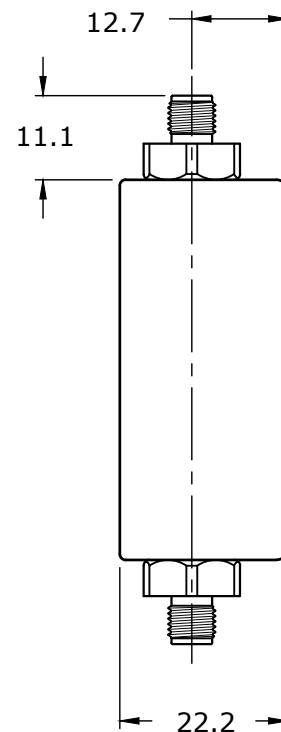
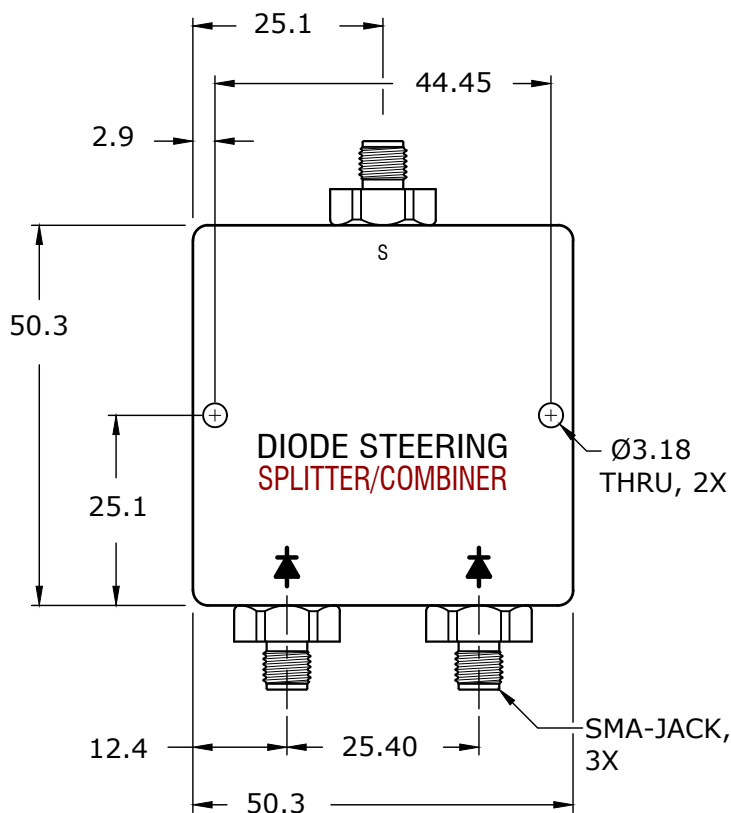

Dimensions in mm

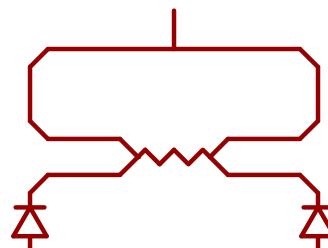

2-Way, Diode Steering Power Splitter Combiner. Accepts Two (2) Uni-Directional DC Inputs Steered Towards a Common Port. Diode Protection Prevents Cross Feeding DC Inputs. Simultaneous Bi-Directional RF; Uni-Directional DC.